



GLOBAL MINING PRODUCTS

Quality, Service, Value

Worldwide Hydraulic Solutions

www.globalminingproducts.net



BEAD BREAKERS

HBB SERIES



Features:

- Works on wheels repair and replacement of engineering and agricultural vehicles.
- Integrated design, Alloy steel claw and chromed pump piston and ram, to increase the strength of overall structure.
- Can use HPA-10001 air pump to supply Hydraulic power.
- HBB-10000 works on all single, two or three piece, 2-5-10 hole budd, 7.50 x 16s and all tubeless truck tires / rims, including new style wheels.
- Working range is up to 5 inches.
- HBB-10001 works on 5 piece rims 25" to 51" with pry bar bead loosening pockets.
- Self Retracting.
- Environment-friendly paint provides a durable anti-corrosion ability.

HBB-10000

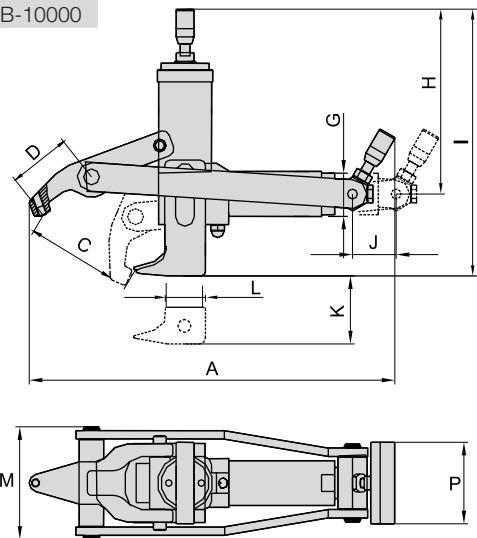

HBB-10001

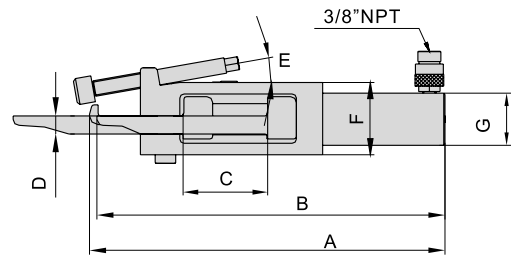

Model	A mm(in.)	B mm(in.)	C mm(in.)	D mm(in.)	E mm(in.)	F mm(in.)	G mm(in.)
HBB-10001	433(17.0)	422.8(16.6)	102(4.0)	22(0.9)	100(3.9)	88(3.5)	64(2.5)

Model	C mm(in.)	I mm(in.)	K mm(in.)	M mm(in.)	P mm(in.)
HBB-10000	130(5.1)	33D(13.0)	95(3.7)	138(5.4)	100(3.9)

AIR HYDRAULIC PUMPS



HPA SERIES

Model	Pressure Rating (psi)	Effective Oil Capacity (cu.in)	Flow (cu.in/min)		Dimensions (in.)			Oil Tank Material	Operating Manner	Weight (lbs)
			No Load	Load	L	W	H			
HPA-10001	10000	98	49.5	7.6	10.3	5.3	7.3	Alloy Aluminum	Foot Petal	19
HPA-10002	10000	275	49.5	7.6	12.5	7	7.5	Steel	Foot Petal	28
HPA-10007	10000	98	49.5	7.6	10.3	5.3	7.3	Alloy Aluminum	Remote Control	25
HPA-10012	10000	275	49.5	7.6	12.5	7	7.5	Steel	Remote Control	28

Features:

- Can be used with a variety of hydraulic cylinders, presses or other hydraulic tools.
- Knob ventilation valve with much better operation and protection.
- Operating air pressure between 0.6 - 1.0 MPa.
- Operating pressure up to 10000 psi.
- Input port thread 1/4" and output 3/8".
- Internal load limiting device avoid overload.
- Air exhaust muffler for quiet pumping of air motor.
- Air and oil filter for reducing risk of damage from outside pollution.
- Varieties of sizes can be chosen, with plastic, aluminum or steel material oil reservoir.



GENERAL PURPOSE SINGLE ACTING CYLINDERS

HCS SERIES



Features:

- Fully comply with ASME B-30.1. High strength alloy steel for durability ensured double-safety.
- Special treatment on cylinder inside for durability.
- Collar threads, plunger treads and base mounting holes enable easy fixturing.
- Heavy-duty plunger return springs.
- High quality 3/8-18NPT quick couplers
- Environment-friendly painting provides a durable anti-corrosion ability.

Cylinder Capacity @700bar	Stroke		Model	Collapsed Height		Extended Height		Weight	
				A		B			
	ton	in		mm	in	mm	in	mm	lbs
10	0.98	25	HSC-10006	3.54	90	4.53	115	3.96	1.8
10	2.13	54	HSC-10007	4.76	121	6.89	175	5.06	2.3
10	4.13	105	HSC-10008	6.73	171	10.87	276	7.26	3.3
10	6.14	156	HSC-10009	9.76	248	15.91	404	9.68	4.4
10	7.99	203	HSC-10010	11.73	298	19.72	501	11.88	5.4
10	10.12	257	HSC-10011	13.74	349	23.86	606	14.08	6.4
25	6.26	159	HSC-10025	10.75	273	17.01	432	22	10

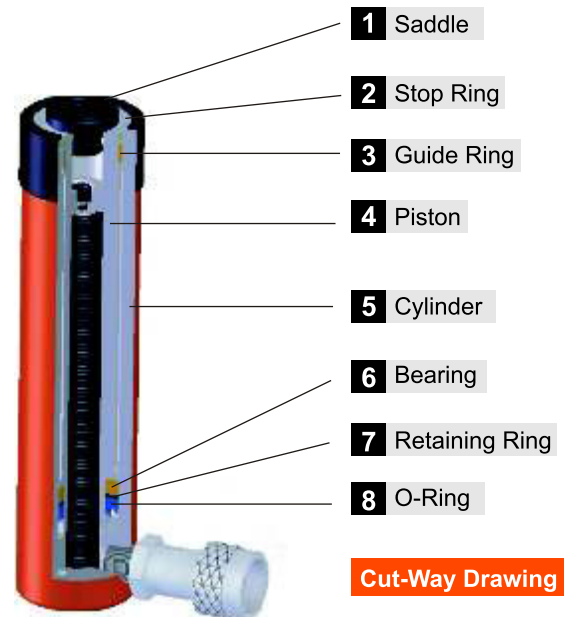

Cut-Way Drawing

SINGLE ACTING ALUMINUM CYLINDERS

HCSA SERIES



Features:

- Low weight, easy to carry.
- High-strength aluminum material with special treatment, wear resistance and corrosion resistance.
- Used in extreme environment.
- Single acting, spring return.
- Comes complete with valve and aluminum base.

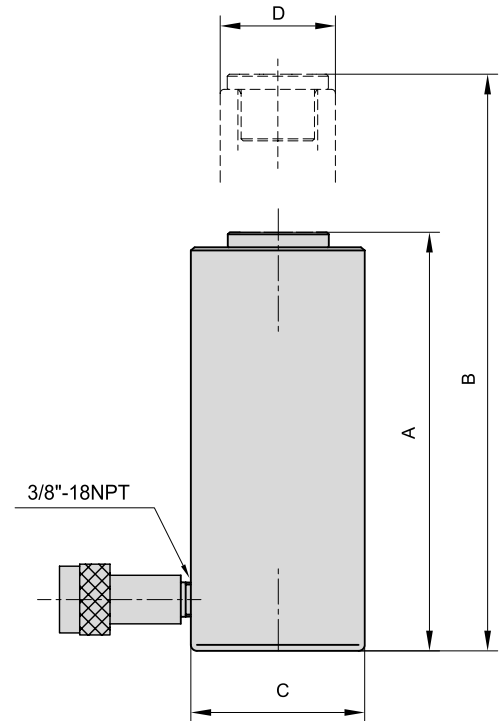

Cylinder Capacity @700bar	Stroke		Model	Collapsed Height		Extended Height		Weight	
				A		B			
	ton	in		mm	in	mm	in	mm	lbs
55	6.10	155	HSCA-10011	10.75	273	16.85	428	24.42	11.1
100	6.26	159	HSCA-10012	11.75	298.5	18.01	457.5	50.16	22.8

SINGLE ACTING LOW HEIGHT CYLINDERS

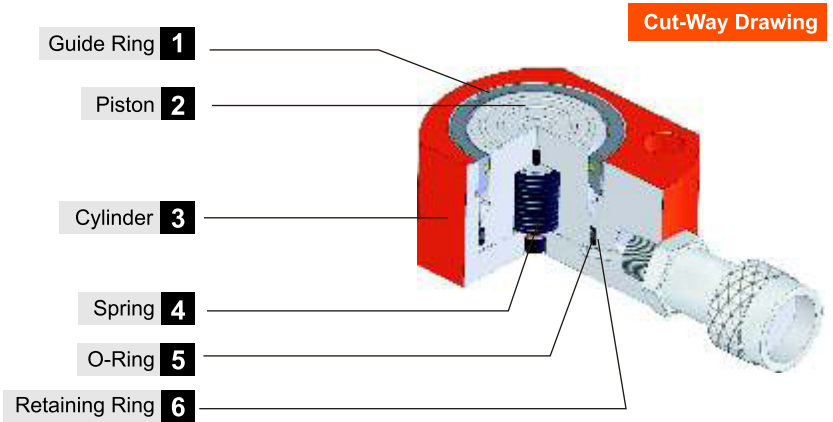

HCSL SERIES

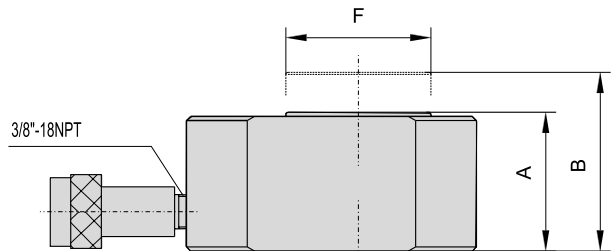
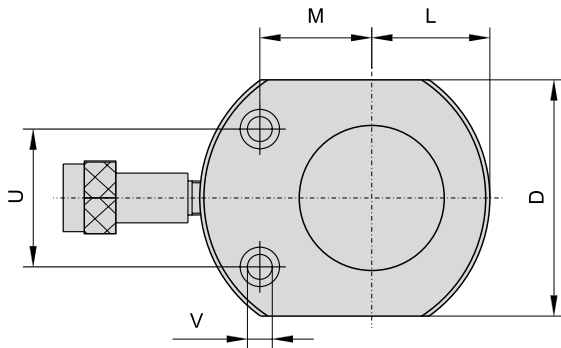

Cylinder Capacity @700bar	Stroke		Model	Collapsed Height		Extended Height		Weight	
	in	mm		A	B	A	B	lbs	kg
10	0.47	12	HCSL-10001	1.69	43	2.13	54	3.08	1.4

SINGLE ACTING HOLLOW CENTER CYLINDERS



HCSH SERIES

Features:

- Hollow Plunger design allows for both pull and push forces.
- Fully comply to ASME B-30.1 high strength alloy steel for durability ensured double-safety
- Single-acting, spring return
- High quality 3/8-18NPT quick couplers.
- Collar threads, plunger threads for easy fixturing.
- Environment-friendly painting provides a durable anti-corrosion ability.

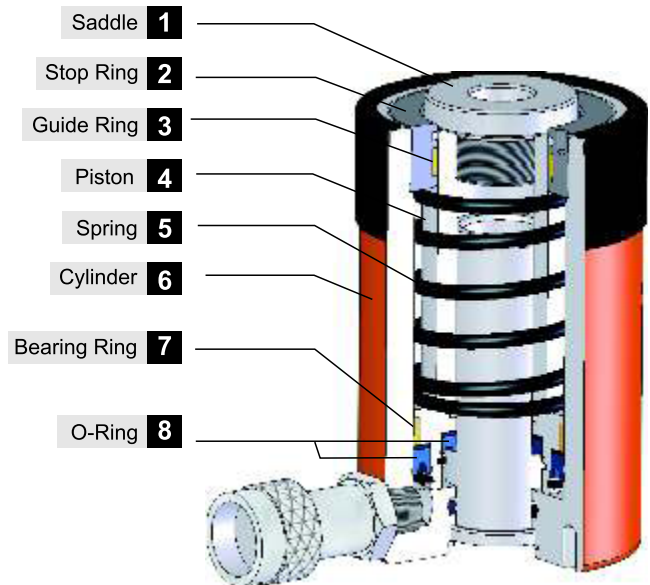

Cut-Way Drawing

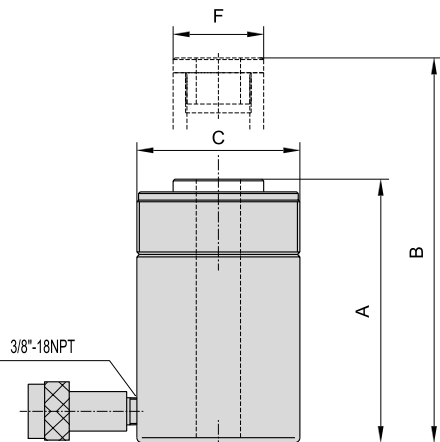
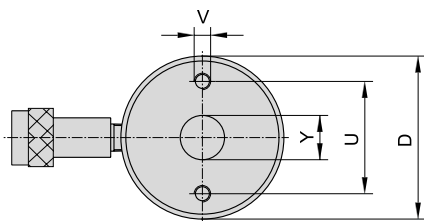

Cylinder Capacity @700bar	Stroke		Model	Collapsed Height		Extended Height		Weight	
	in	mm		A		B		lbs	kg
20	1.9	49	HCSH-10005	6.4	162	8.3	211	16.94	7.7
20	6.1	155	HCSH-10006	12.0	306	18.1	461	31.02	41.1

TELESCOPIC AIR TROLLEY JACK

Features:

- Provides quick and effortless lifts for rated capacity loads
- Two stages, Three stages or more stages
- Quick lift without load
- Self retracting by air
- Long T-handle allows you to easily position your jack under vehicle
- High polish chromed piston rods and cover board for long time use.



Picking handle can be folded for space saving.



Heavy Duty Wheels



30/15Ton Capacity
JCK-A1031

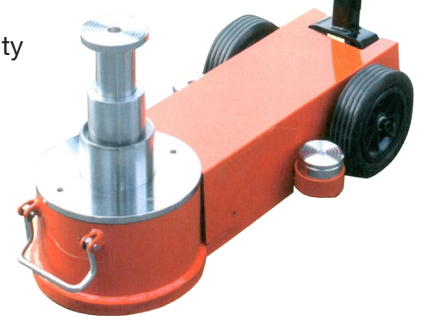

50/25/10Ton Capacity
JCK-A1032

Model	Capacity	Min. Height	Max. Height	Air Pressure	N.W	Package Size
JCK-A1031	30/15ton	150mm(5.9")	300mm(11.8")	0.7-1.0MPa	48Kgs	670x335x175mm
JCK-A1030	25/10ton	150mm(5.9")	306mm(12")	0.7-1.0MPa	43Kgs	680x330x200mm
JCK-A1032	50/25/10ton	150mm(5.9")	367mm(14.4")	0.7-1.0MPa	65Kgs	720x355x200mm

AIR SERVICE JACKS

Features:

- Welded base and cylinders to assure strength and eliminate leaks
- Chromed pump piston and ram for added rust resistance.
- Self retracting
- One-piece handle alternative two-piece handle
- Meets ANSI/ASME PALD standards & CE/GS

JCK-A1010
22Ton Capacity
High Profile



JCK-A1011
22Ton Capacity
Low Profile



SINGLE STAGE

Model	Capacity	Min. Height	Max. Height	Air Pressure	Net Weight
JCK-A1010	22ton	210mm(8.9")	525mm(20.7")	0.7-1.0MPa	46Kg (101.4Lbs)
JCK-A1011	22ton	185mm(7.3")	465mm(18.3")	0.7-1.0MPa	46Kg (101.4Lbs)
JCK-A1012	35/22ton	216mm(8.5")	502mm(19.8")	0.7-1.0MPa	50Kg (110Lbs)
JCK-A1013	40/20ton	175mm(6.9")	435mm(17.1")	0.7-1.0MPa	49Kg (108Lbs)

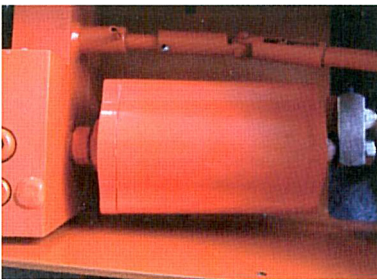

High performance air motor provides powerful and durable supply



Welded structure and high strength steel base ensure the best performance

DOUBLE STAGE

JCK-A1012
35/22Ton Capacity



JCK-A1013
40/20Ton Capacity



**GLOBAL MINING
PRODUCTS**

Quality, Service, Value

www.globalminingproducts.net

AIR/MANUAL BOTTLE JACK

Features:

- Welded base and cylinders to assure strength and eliminated leaks
- Chromed pump piston and ram for added rust resistance
- Extension screw gives added height when necessary
- Power provided by manual force or air motor
- Meets ANSI/ASME PALD standards & CE/GS

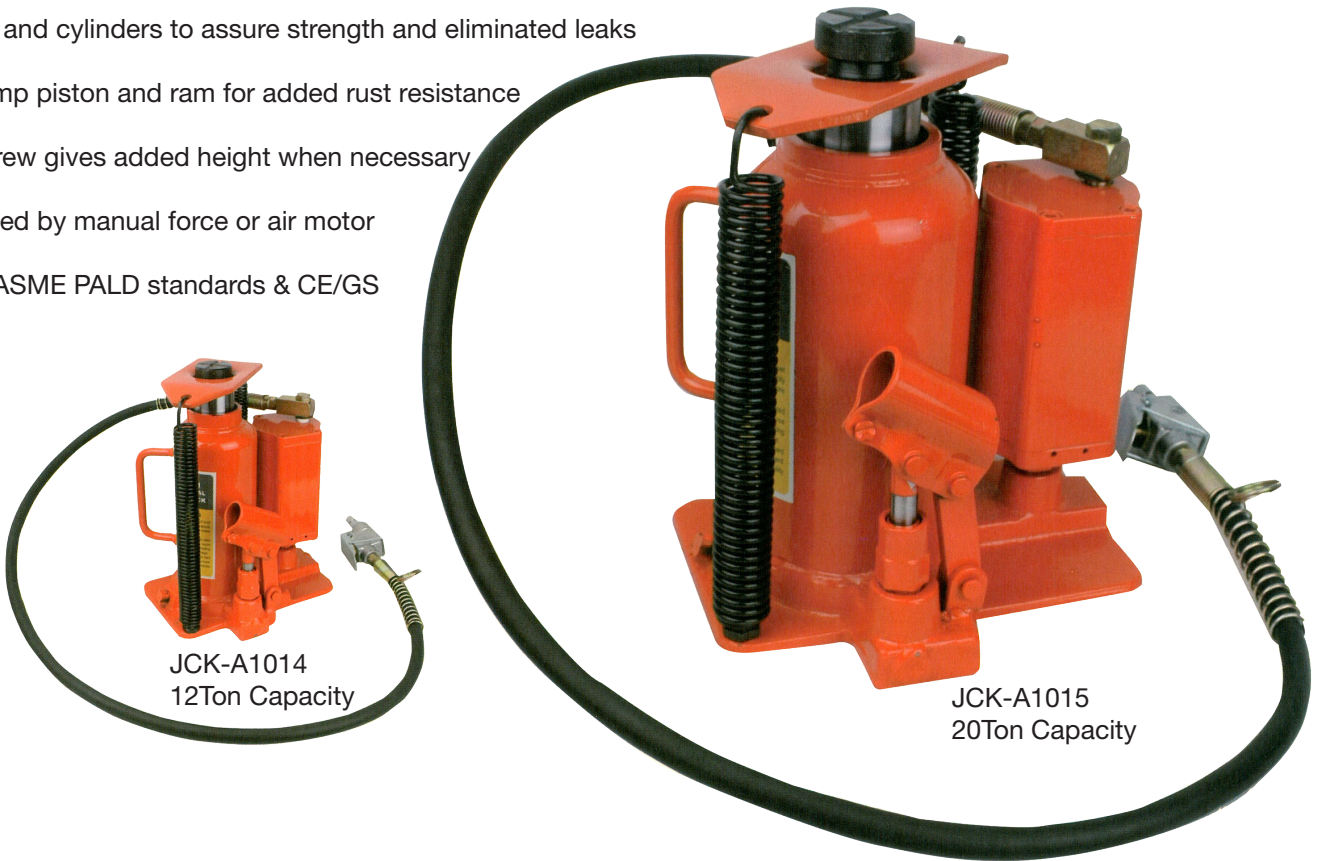

JCK-A1014
12Ton Capacity

JCK-A1015
20Ton Capacity

CART MODEL



JCK-A1016
20Ton Capacity

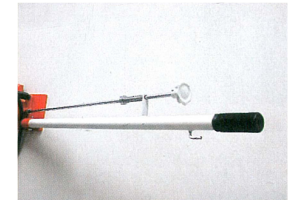

Cart design makes the jack convenient for moving

Long handle and release knob realize long distance operation

Model	Capacity	Min. Height	Max. Height	Air Pressure	Net Weight
JCK-A1014	12ton	245mm(9.6")	475mm(18.7")	0.7-1.0MPa	11Kg (24.3Lbs)
JCK-A1015	20ton	245mm(9.6")	475mm(18.0")	0.7-1.0MPa	16Kg (35.3Lbs)
JCK-A1016	20ton	253mm(10.0")	483mm(19.0")	0.7-1.0MPa	23Kg (50.7Lbs)

WHEEL DOLLY

Features:

- Easy installation and uninstallation of truck wheel assemblies
- Compact design makes one person operation possible
- Heavy duty industrial bearings
- Three positions for rollers depending on wheel size
- Avoid damage to wheel bolts and expensive modern rims
- For all wheels from 6.5" - 22.5"

Model	Capacity	Suitable wheel size	Net Weight
WD-10000	250kg (550lbs.)	6.5" to 22.5"	12.5Kg (27.5Lbs.)



WD-10000
250Ton Capacity

WHEEL DOLLY

Features:

- Remove, transport, and replace dual wheels and tire assemblies effortlessly.
- Swivel casters, 3-1/2" front and 3" rear, provide easy maneuverability.
- Floor space is 43" by 42".
- Hydraulic bottle jack provides over 6-1/2" of lift and tilts wheel assembly 7° to prevent damage to wheel seal.
- Includes an 6' support chain to hold load in place.



WD-10001
1500Lbs. Capacity

Model	Capacity	Net Weight
WD-10001	1500 Lbs.	85Kg (187Lbs.)

DUAL WHEEL DOLLY

1/2TON CAPACITY TELESCOPIC TRANSMISSION JACK



Features:

- Single stage telescopic ram for economical use.
- Simple adaptor provides convenient operation.
- Wide base for maximum stability.
- Convenient release knob design.
- Foot-operated pump frees both hands for easier saddle-to-transmission alignment.

Model	Capacity	Min. Height	Max. Height	Net Weight
JCK-A1029	1/2ton	1100mm(43.3")	1900mm(18.7")	11Kg (24.3Lbs)



OPTIONS

